

Data Sheet

Reference No.:36492

Surface Grinder, horizontal

Brand: ABA
 Model: PSM 1250 TT
 YoM, approx.: 1991 used
 Reconditioned:
 Controls: CNC controls SINUMERIK 880-M



Working Range Surface Grinding

grinding length: 1000 mm
 grinding width: 280 mm

table (surface grinding)

table surface (left-right): 800 mm
 table surface (front-back): 350 mm
 magnetic table: yes

magnetic table

length: 800 mm
 width: 400 mm
 distance between poles: 25 mm
 weight: 1250 kg

Spindlestock Grinding Spindle

X-axis travel: 2000 mm
 Y-axis travel: 600 mm
 Z-axis travel: 280 mm
 spindle revolutions (min): 50 /min
 spindle revolutions (max): 8000 /min

Grinding Tool

type of grinding tool: wheel
 diameter (max): 500 mm
 borehole: diameter: 203.2 mm
 width: 125 mm

Axis Drives

traverse velocity X (min): 10 mm/min
 traverse velocity X (max): 24000 mm/min
 traverse velocity Z (max): 1500 mm/min

Electrical specifications

mains voltage: 400 V
 mains frequency: 50 Hz

Dimensions / weights

space requirements -left/right-: 6300 mm
 space requirements -front/back-: 5400 mm
 total height: 2950 mm

Additional Information:

Machine features:

- 2 pallet changing table $\pm 180^\circ$ version (hyd.clamped).
- Rotary indexing table $\varnothing 1250$ mm

Machine equipment:

- Full shuttering
- 2 magnetic plates 800x350mm
- dressing rolls $\varnothing 130 \times 125$ mm (400-4000rpm)

Profile grinding machine

Dynam. balancing unit

Profile grinding unit (mounted on grinding table)

- Diamond rolls $\varnothing 140 \times 130$ mm (speed 3000rpm)

Machine enabled for creep grinding

Dismantling and loading cost of 5'500 EUR will be charged separately

Seller:

ProdEq Trading GmbH
 Frank Goedicke
 Reckholder 1, 9527 Niederhelfenschwil, Switzerland
 +41 71 948 70 60
 frank.goedicke@prodeq.ch

Photos & Documents

Reference No.: 36492



Grinding Area



Electrical Cabinet



Grinding Disc Housing Open



Rear View



Control Panel

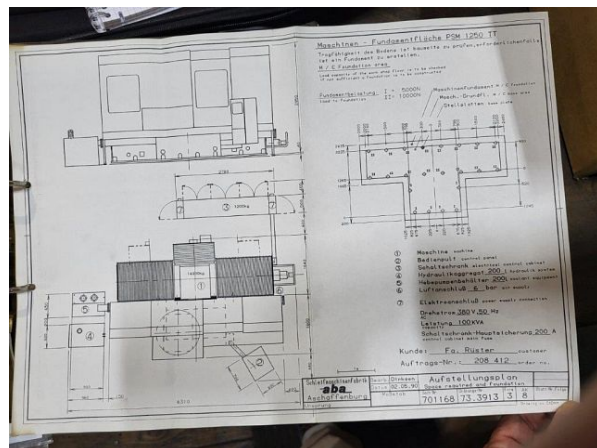

Layout